

October 2010

Edition 5

New Farr Cruisers Worldwide Debut

The Amsterdam Boat Show held host to the worldwide premiere of the latest designs to come out of the collaboration between Bavaria Yachtbau, BMW Designworks USA and Farr Yacht Design.

Bavaria showed off the new 36 Cruiser alongside the 40 Cruiser. The new models feature the huge swimming platform, large roomy cockpit and voluminous interior that has been well received on the 32,45 and 55 Cruiser model so far.

The 36 is priced from \$261,000 (2 cabin version, 3 cabins available) and the 40 (3 cabin only) is positioned at \$325,000 inc GST



Our Brokers

Colin Rees
029 969 1221

Peter Broadhurst
029 969 1223

Or both can be reached on

09 302 1220

Busfield Marine Brokers
23b Westhaven Drive
Westhaven
Auckland 1010

PO Box 90 141
Auckland Mail Centre

Ph (09) 302 1220

Owners Evening – Doyle Sails

On the 14th July Busfield Marine hosted their first Owners Evening at the Doyle Sails Loft on Rosebank Rd, Avondale. Around 20 owners braved the Auckland Traffic and winter cold to listen to the boys from Doyles talk about the various different aspects of sailmaking and canvas work.

After a few drinks to get the conversation flowing a tour of the facility got underway where the Owners viewed the loft, the canvas and upholstery section and the new high tech Stratis Sailloft. During the tour Andy, Simon and Rob gave an informative presentation on the different types of sails and materials available.

After the tour everyone adjourned to the relative warmth of the staff cafeteria for more questions and a few more drinks. Doyle Sails graciously provided a Stratis jacket for a prize draw which was won by Ray Davis - Tickity Tack. Thanks must go to all the crew out at Doyles for hosting such an entertaining and informative evening.





New Cruiser 32 — Owner Review

We have just returned from a four day shakedown cruise in our new B32 and first impressions are very positive. Although primarily designed as a comfortable cruiser, the boat sails well with a lovely light helm, recording 6 knots upwind, and over 8 knots with eased sheets. The fractional rig, with a blade jib, means she points high and is responsive to sail trim. The boat feels stiff and has a nice motion even when hard pressed. We experienced winds in excess of 30 knots and while far from ideal conditions, the boat looked after her crew and we made it to our next anchorage without too much fuss. Because the main sheet is easily controlled from the cockpit it makes sailing in a blow a much more relaxing experience.



Inside the set-up is modern and comfortable. It has a large head and both cabins work well given the limitations of a 32ft yacht. The saloon can easily accommodate 6 adults for dinner, and indeed our friends have nicknamed the boat "the Tardis" for its deceptive interior volume! Finally the boarding platform is an outstanding piece of design, great for getting in-and-out of the tender, fishing and of course a relaxing sun-downer.

Brian and Michele 'Lime'.

Thanks to Brian & Michele for this contribution



Nav Station Specials - Owners Exclusive

MS— IP600
IPOD Compatible
Was ~~\$665~~ **NOW \$565**



Garmin 750s

7" colour touchscreen
GPS/Fishfinder pre-
loaded with NZ/Aus
Charts with thru-hull
transducer
Was ~~\$2700~~ **NOW \$2400**



Garmin 5012

12" colour touchscreen
GPS/Fishfinder, NZ
Charts, Sounder module
with thru-hull transducer

Was ~~\$5813~~ **NOW \$5099**



ICOM M33
Handheld
VHF

Was ~~\$425~~

NOW \$379

Please contact the Nav Station on 09 3099942 or sales@navstation.co.nz to purchase

Busfield Marine Brokers
23b Westhaven Drive
Westhaven
Auckland 1010

PO Box 90 141
Auckland Mail Centre

Ph (09) 302 1220



Bavarias for Sale

**USED BOATS
NEEDED!!**

Help

We require stock of good used Bavarias. We are fielding requests almost daily.

We would welcome the opportunity to sell your yacht.



Cruiser 45 Interior

Busfield Marine Brokers
23b Westhaven Drive
Westhaven
Auckland 1010

PO Box 90 141
Auckland Mail Centre

Ph (09) 302 1220



Cruiser 36

2005 model. 2 Cabin layout. Fully battened mainsail plus 2 x #1 genoas on furler, spinnaker. Well spec'd and beautifully presented

\$225,000



Match 42

2005 yacht. 53Hp motor, large wardrobe of quality sails. 3 cabin layout. Good electronics. Well priced.

\$270,000



Cruiser 44

2001. 5Hp motor 850hrs approx. Feathering prop. Standard plus Doyles High Performance sails. 3 Double cabins. Broadwater stove. 2 Heads. Separate electric fridge and freezer. 3 Showers. Comprehensive Electronics. Dinghy/ OB



Cruiser 39

07 Model, 55Hp motor, low hours. High tech sails with vertical battens. In mast furling. 3 Cabins Good electronics. Very tidy boat



Cruiser 50

2005. 75 hp motor. 4 cabin layout, cutter rigged. Recent entrant in Sydney to Hobart. Extensive sail wardrobe. Full electronics. Very competitively priced



Cruiser 38

As new. 2008. Only 170NM on the log. 40hp motor, fully furling rig. Absolutely immaculate condition. 3 double cabin layout. L-shaped galley



Cruiser 40

Near New. Available now. \$60 000 of extras. Fully furling rig, large autopilot, radar, GPS/chartplotter, 40hp motor, large battery bank, inverter and spray



New Boats

August and September were busy months for Busfield Marine with the launching of 5 new Bavarias and the completion of a sale agreement on another yacht due to arrive shortly. When the new Cruiser 32 dips it's keel into the water before Xmas it will mean that 7 new Bavarias have been launched in 2010 in NZ. With the development of the new Cruiser range and the Vision series continuing we are eagerly looking forward to 2011.



Cruiser 40

New Boat Pricing

Cruiser 32*	\$167,555
Cruiser 36	\$261,000
Cruiser 40	\$325,000
Cruiser 45	\$416,029
Cruiser 47	\$449,782
Cruiser 51	\$550,817
Cruiser 55*	\$669,477
Vision 40	\$357,492
Vision 44	\$424,873
Vision 50	\$533,375

Based on current exchange rates as at 13/10/2010

Current specials on the Vision Series are not shown above. Please contact our Brokers

*Cruiser 32 and 55 are standard spec only. No extras

DEMONSTRATION MODELS - 36 & 40

The new Farr/BMW designed 36 & 40 Cruiser series are boats that we believe have great potential here in New Zealand. We are looking for owners in the Auckland area that would allow us to use their boats for Boatshows and to show to potential clients. Any interested parties can expect a very favourable deal on their new boat. First come, first served. Please contact Colin or Peter on 09 302 1220 to discuss.

NEW RELEASE - CRUISER 50

Bavaria continue to re-release new models at an astonishing rate. Completing the new Farr designed Bavaria Cruiser line up is the new Cruiser 50.



The new yacht will feature dual rudders, a huge bathing platform and headroom (2.11m) in the saloon that many other brands can only dream of.

A five cabin / 3 head version will be launched in January at the Dusseldorf Boat Show followed by a 4 cabin version later in the year.

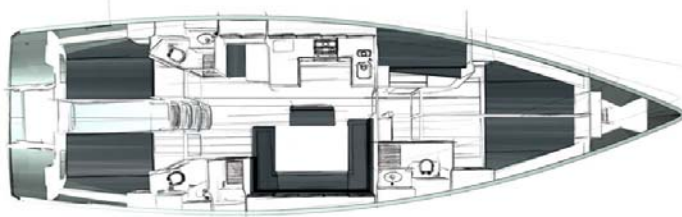

Busfield Marine Brokers
23b Westhaven Drive
Westhaven
Auckland 1010

PO Box 90 141
Auckland Mail Centre

Ph (09) 302 1220



Owner Review— Cruiser 34 — Bella Vista



Cruiser 40

After many years of power boating and of talking about spending more weekend time on the water the Grigg family are finally the proud owners a new Bavaria 34 Cruiser. Unfortunately the weather gods have not seen fit to throw many good days our way so far but we are hoping that will change as we approach summer and we will be able to realize the dream.

The experience we have had through the purchase process with Busfield Marine has been great with no surprises and a great deal of help and guidance thanks to the team. The sea trial day was a lot of fun with 27 knots on the nose and the boat handled superbly under the expertise of Peter and Colin even if we did get a little wet.

The delivery trip to home base at Half Moon Bay was done late afternoon the following Sunday once the wind had died down and was a pretty nice run under motor but it was dark by the time we got to the mouth of the Tamaki river so we quickly developed an appreciation for the Garmin GPSMAP 750s Chart plotter and managed to get to our new berth without too much drama and cursing.

We have managed to do a couple of day trips since but are hoping Labour weekend will provide the first chance to stay overnight. Here's hoping. Thanks again to the Busfield team for a great product and service to match.

Cheers, the Grigg Family

LED Lighting — an amazing power saver



We have had a few requests from owners looking at replacing the bulbs on board with something more efficient.

Mark Thetford (North Harbour Marine) has had success with this range for both interior and nav lights. One recent installation dropped the amp draw from over 10amp to around 2amps.

This bulbs are available from the **Nav Station** from \$17 upwards or we can organize Mark to fit them on your vessel

09 3099942 or Mark 021 985 298

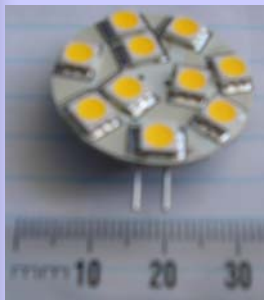

WHY UPGRADE TO LED LIGHTING?

- Very low power draw
- Low heat generation
- Long life (approx 40,000 hours)
- Shock & vibration resistant
- Now available in new 'warm' tones
- Instant on / off
- Longer intervals between battery charges
- Drop in replacement - retrofits easily into most existing halogen or incandescent lamps

• **Up to 90% Power Saving.**

Busfield Marine Brokers
23b Westhaven Drive
Westhaven
Auckland 1010

PO Box 90 141
Auckland Mail Centre

Ph (09) 302 1220





Vision Factory Specials

Bavaria are offering some specials on the Vision series. The Vision range has been popular in New Zealand with 2 Vision 40s sold this year alone. The interior is roomy and spacious and the large number of hatches allow lots of natural light into the cabin to create a very luxurious feel to the boat. The Vision series also come with a lead keel as standard and a higher level of specification than the Cruiser range.



Ask about the Factory Specials today!



Cruiser 45



Lewmar Folding Wheel Offer



Need a little more space in the cockpit?

As part of the close relationship Bavaria has with Lewmar we are pleased to offer all Bavaria Owners the chance to purchase the Lewmar folding wheel at a special price.



WAS \$1599 NOW only \$1100 inc GST

Burnsco Marine - Bavaria Owners Cash Account

Good news — A cash account for Bavaria Owners has been set up to allow Bavaria owners to buy at significantly better than retail prices or even the cardholder prices any of the 12 Burnsco Marine Stores

throughout New Zealand. Just tell the staff that you are a Bavaria Owner and wish to use the Bavaria Owners Account for your purchases and they will apply the discount.



Auckland Anniversary Regatta — Bavaria Race

Busfield Marine have been talking to the Organizers of the Oceanbridge Auckland Anniversary Regatta 2011 about staging a race specifically for Bavarias. This class would be dependent on receiving sufficient numbers to make a race worthwhile. The entry fee would be \$25 and the race format and layout is yet to be decided. If you are interested in entering this event please email will@busfieldmarine.co.nz so we can judge the level of interest for this year's Regatta.

Busfield Marine Brokers
23b Westhaven Drive
Westhaven
Auckland 1010

PO Box 90 141
Auckland Mail Centre

Ph (09) 302 1220

